

Cover Locks Installation Instructions

Included in kit:



Lock Brackets



Clevis Pins



Cotter Pins

What you will need:



Drill with 9/64" bit and 3/16" bit



Marking Pen



#10 Fastening Screws*
(2 per lock)

*Fastening screws are supplied by customer and should be appropriate for material being fastened to (brick, plastic, metal, concrete, etc.). Use a minimum screw length of 13/4" to ensure proper engagement.

Installation:

STEP 1: From inside the window well, align the Lock Bracket so that the top of the bracket is flush with the bottom surface of the polycarbonate cover.

STEP 2: Use the marking pen to mark two bracket hole locations on well.

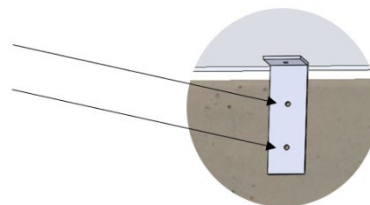
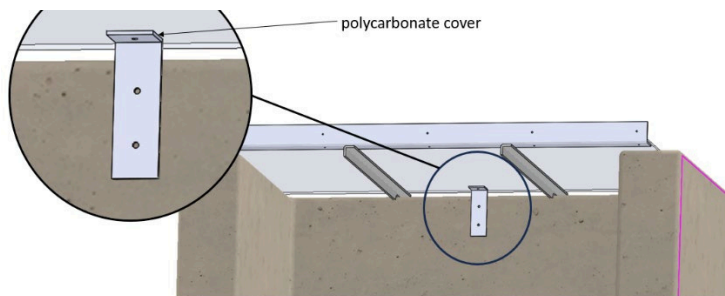

STEP 3: Use a 9/64" drill bit to drill two pilot holes in marked locations. Fasten the Lock Bracket to the well using appropriate #10-24 screws.

STEP 4: From top side of cover, drill a 3/16" hole into the polycarbonate cover that aligns with the top hole in the Lock Bracket

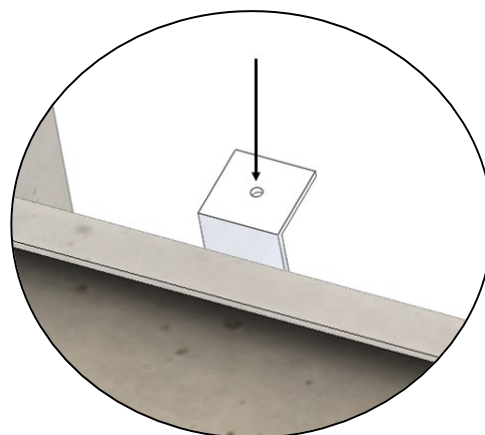
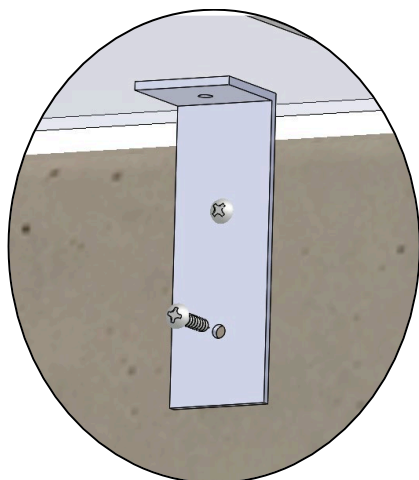

Cover Locks Installation Instructions

(Continued)

STEP 5: Insert clevis pin through top side of cover, into the Lock Bracket.

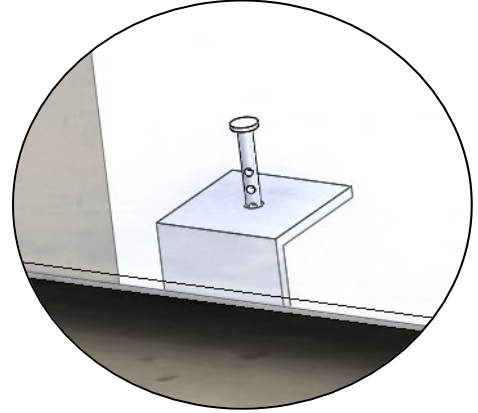

STEP 6: From inside the window well, insert cotter pin through clevis pin to secure lock.

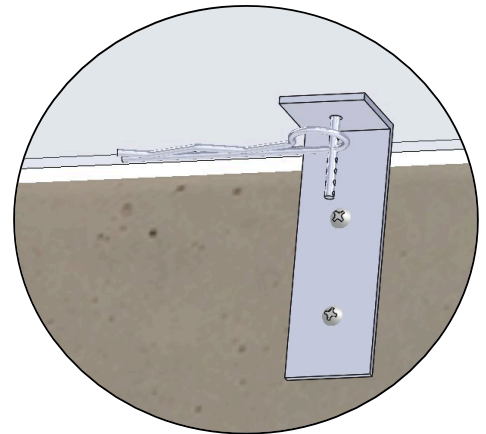

STEP 7: Repeat steps 1-6 with the remaining locks. Be sure to use all locks provided and space them evenly. This will ensure that the polycarbonate cover cannot be flexed enough to allow access to the lock from outside of the cover.

For questions, please call Window Well Supply Customer Service
Monday through Friday, 8:00AM – 5:00PM CST at (262) 633-3707.